

БЛSD.010201.300 Г4

БЛSD.010201.300

Спраб. №

Подп. у дата

Инд. № дудл.

Взам. инд. №

Подп. у дата

Инд. № подл.

Fig.1 A rotor assembled with a stator

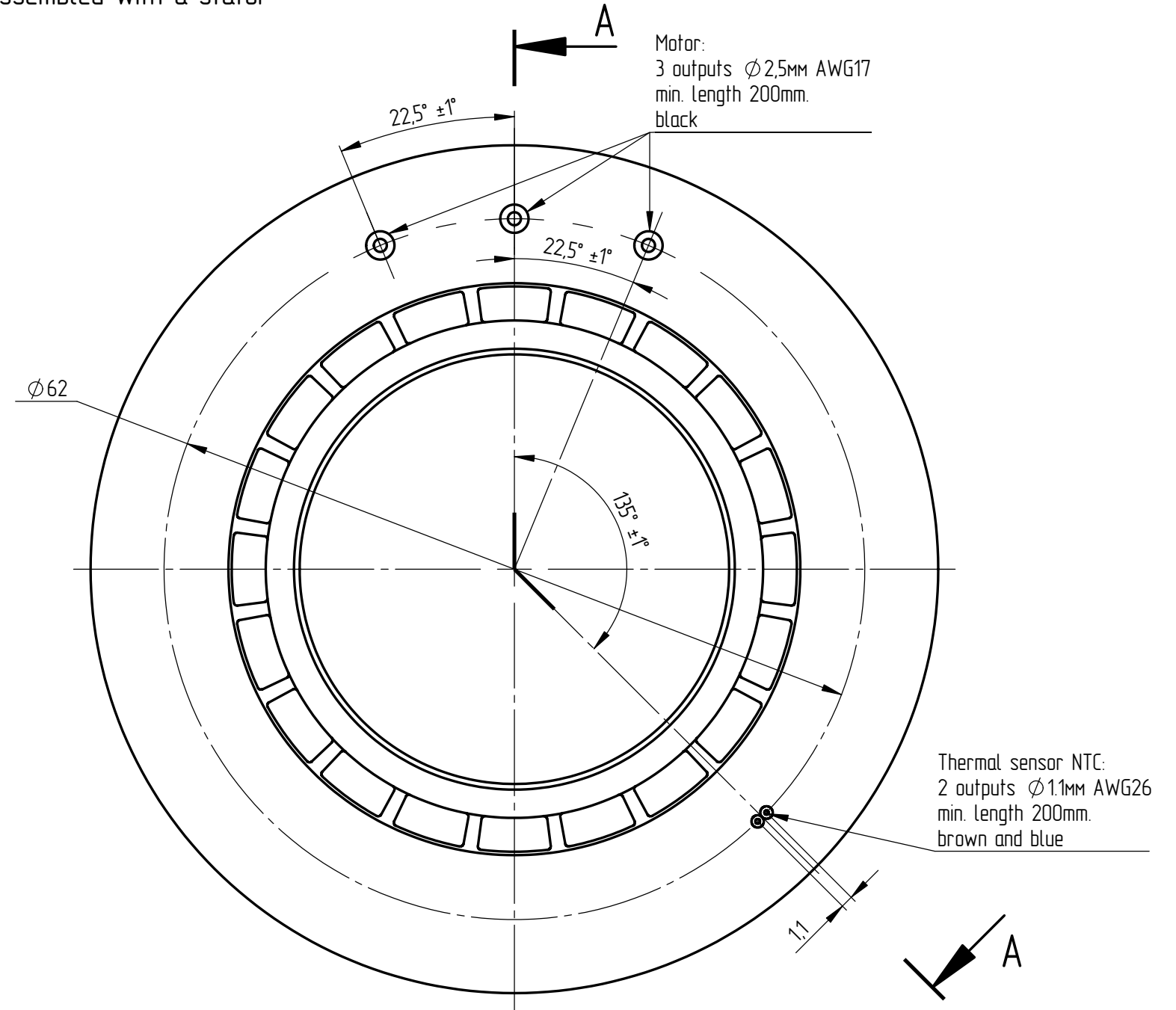
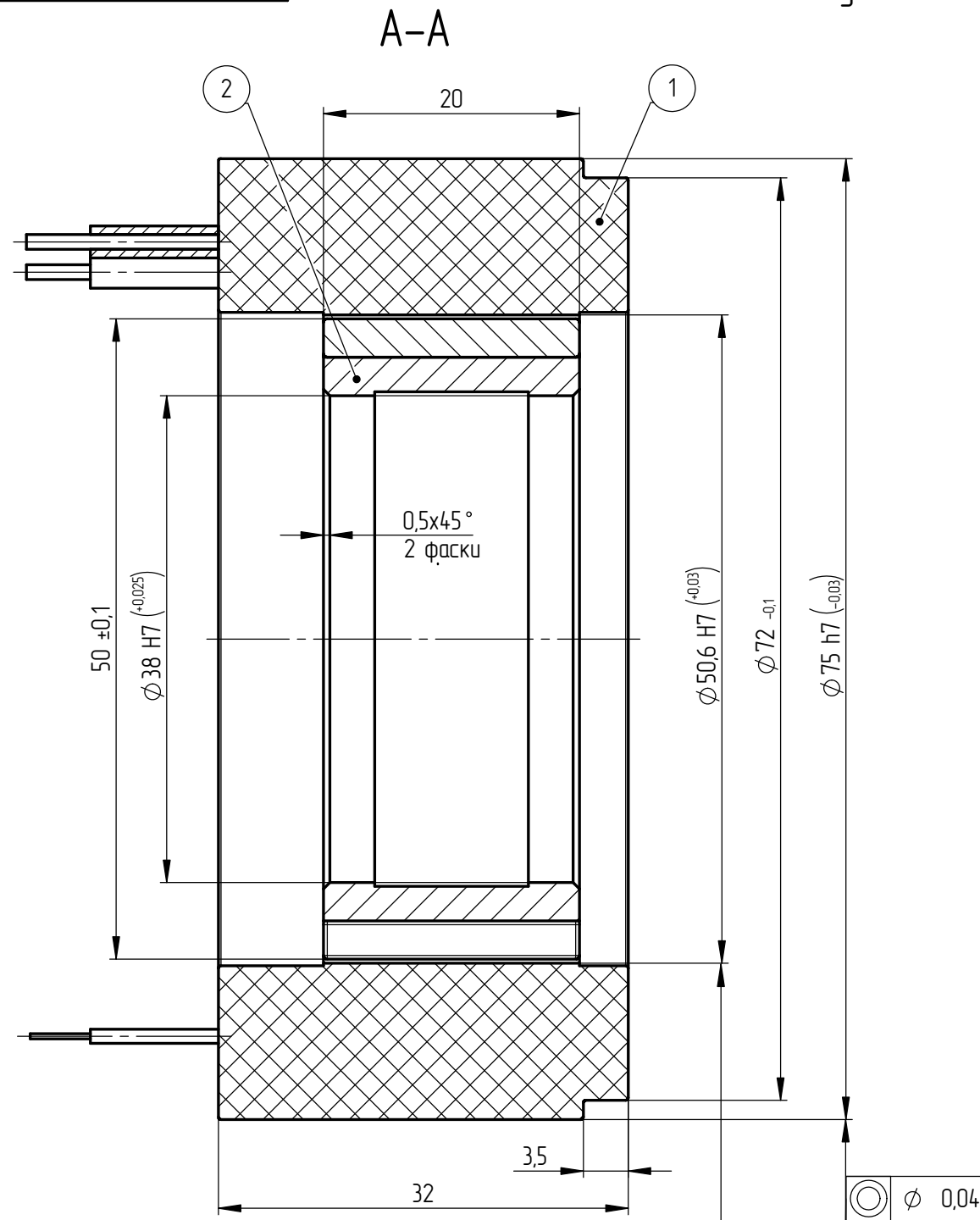

Motor:
 3 outputs Ø2.5mm AWG17
 min. length 200mm.
 black

Thermal sensor NTC:
 2 outputs Ø1.1mm AWG26
 min. length 200mm.
 brown and blue

1. The dimensions are for reference.
2. Round off sharp edges to a chamfer of $0,2^{+0,2} \times 45^\circ$ or a radius $R0,2^{+0,2}$.
3. The unspecified radiuses of fillets are $R0,5$ max.

	Identification	Designation	Q-ty
1	BLDS.010201.310	Stator	1
2	BLDS.010201.320	Rotor ring	1

Rev.	Sheet	Document №	Signature	Date
		Rabtsevich		04.02.19
Designed by				
Checked by				
T. check				
Norm.check				
Appr. by				

БЛSD.010201.300 Г4

Frameless motor
 FMI852001
 Dimension drawing

Letter	Weight	Scale
	0,48	2:1
Sheet 1	of 2 sheets	



Fig. 2 The rotor-stator assembly in a housing

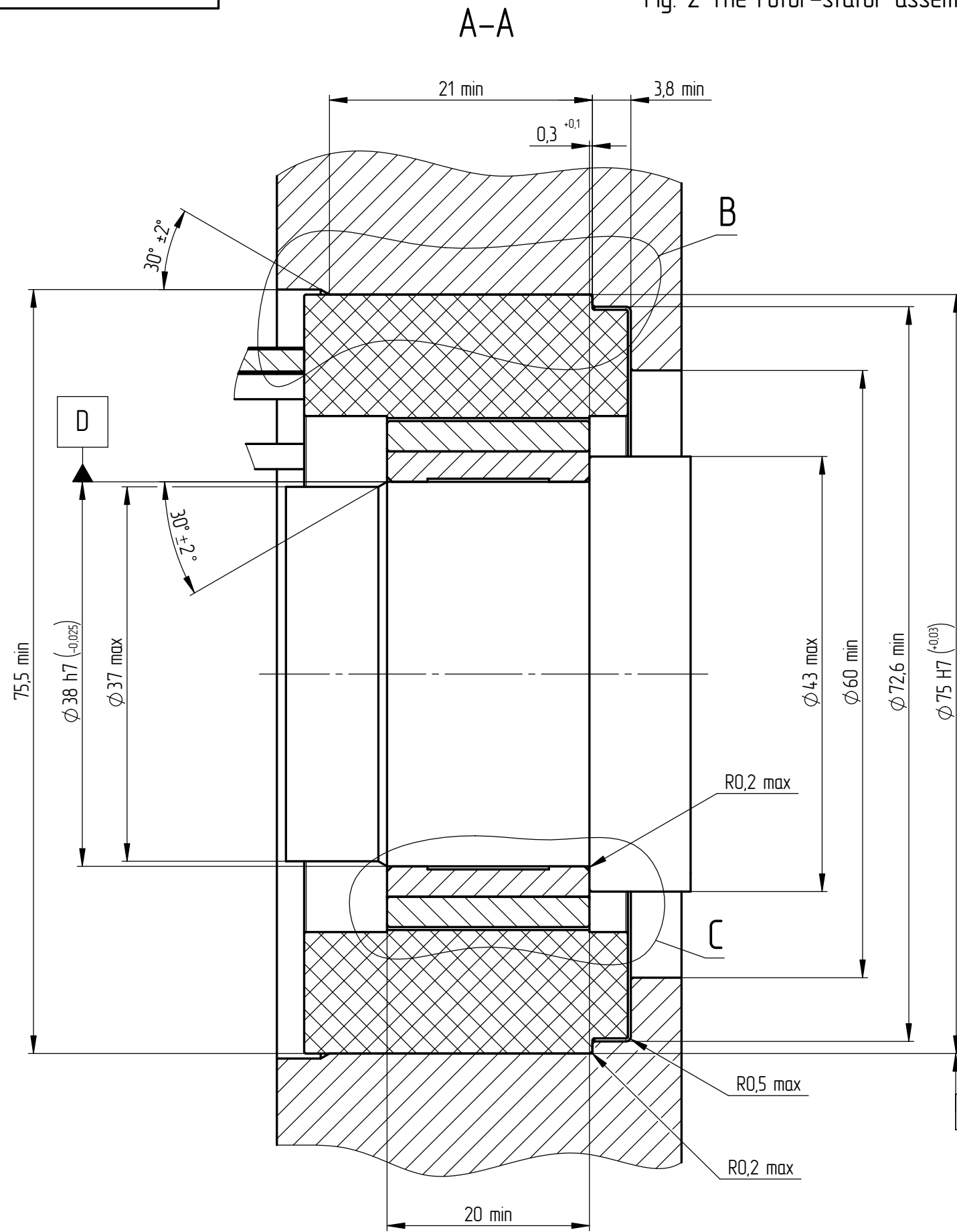

B (2.5 : 1)

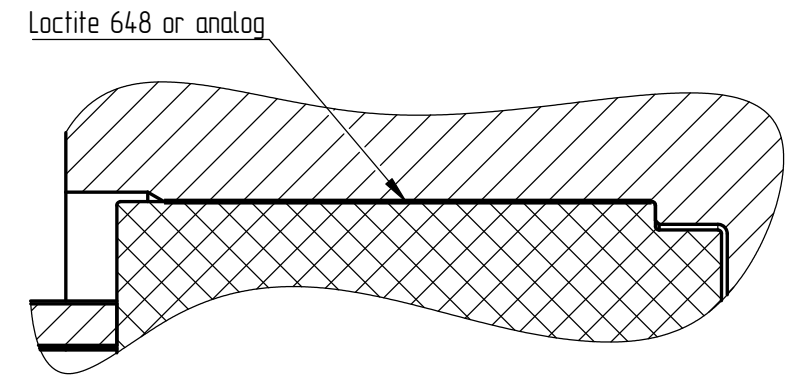

C (2.5 : 1)

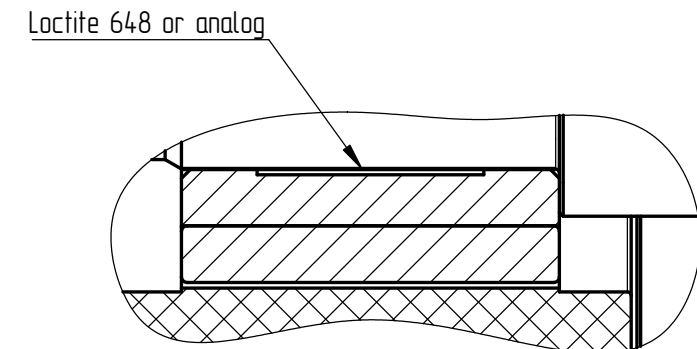

$\phi 0,05 \text{ D}$

Инд. № подл.	Подп. и дата	Взам. инд. №	Инд. № дубл.	Подп. и дата

Rev.	Sheet	Document №	Signature	Date